

**HEAVY WEIGHT
WINCH SERIES**



WARN M15000 Enough capacity for the heaviest loads

A heavy-duty 15,000 lb. capacity winch with a 4.6hp series-wound motor. Direct drive cone braking system. Control pack is designed for clearance and ease of access. Large-frame architecture means this winch will stand up to the stresses of heavy winching.

- High strength carrier plates are designed to handle heavy geartrain stresses
 - Series-wound, high-speed motor provides fast line speed and strong pulls
 - Brake provides superior control while winching
 - Remote-mount control box allows for various mounting options
 - Durable 3-stage planetary geartrain for smooth, reliable, operation
 - Remote control with 12' (3.7m) lead
 - Chip-resistant powder-coated finish
 - 90' of 7/16" (27m of 11mm) diameter wire rope
- PN 47801 (12V)**
PN 478022 (24V)



**HEAVY WEIGHT
WINCH SERIES**

WARN M12000 A reliable workhorse to meet heavy winching needs

Big torque, power, and fast no-load retrieval speed. 3-stage planetary geartrain combined with a 4.6hp series wound motor produce 12,000 lbs. of pulling power. Low profile design so it fits where you want it.

- Large frame winch design to handle heavier winch loads
 - Series wound, high-speed motor provides fast line speed and strong pulls
 - Brake provides superior control while winching
 - Remote-mount control box allows for various mounting options
 - Durable 3-stage planetary geartrain for smooth, reliable, operation
 - Remote control with 12' (3.7m) lead
 - Chip-resistant powder-coated finish
 - 125' of 3/8" (38m of 9.5mm) diameter wire rope
- PN 87801 (CE, 12V), PN 265072 (24V),**

SPECIFICATIONS:

Winch model: M15000
Part numbers: 47801 (12V), 478022 (24V)
Rated line pull: 15000 lbs., (6804 kgs) single-line
Motor: Series wound, 12V 4.6 hp, 24V 2.5 hp
Electrical controls: Contactor
Remote Control: Remote switch, 12' (3.7m) lead
Geartrain: 3-stage planetary
Gear ratio: 315:1
Clutch (freespooling): Rotating Ring Gear

Brake: Automatic direct drive cone
Drum diameter/Length: 3.5"/8.2" (9cm/21cm)
Weight: 136 lbs. (62 kgs)
Wire rope: 90', 7/16" (27m, 11mm) diameter
Fairlead: Roller
Recommended battery: 650 CCA minimum for winching
Battery leads: 2 gauge, 72" (1.83m)
Finish: Argent gray powder coat

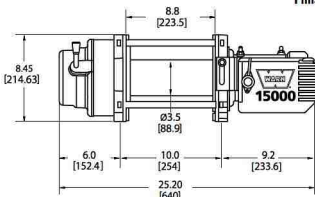

Winch Dimensions:
25.2" L x 8.5" D. x 11" H.
(556mm L x 215mm D. x 279mm H.)

Mounting Bolt Pattern:
10.0" x 4.5"
(254mm x 114.3mm)

12V DC performance specs (first layer of drum)

Line Pull Lbs. (kgs)	Line Speed Ft./min. (M/min.)	Motor Current	Pull by layer: layer/Lbs (kgs)
0	22.2 (6.77)	67 amps	1/15000 (6804)
2000 (910)	7.27 (2.22)	135 amps	2/13890 (6300)
4000 (1810)	5.41 (1.65)	185 amps	3/11520 (5225)
6000 (2720)	4.43 (1.35)	235 amps	4/9840 (4463)
8000 (3630)	3.79 (1.16)	285 amps	
10000 (4540)	3.31 (1.01)	335 amps	
12000 (5440)	2.93 (.893)	385 amps	
14000 (6350)	2.61 (.796)	435 amps	
15000 (6800)	2.48 (.756)	460 amps	

24V DC performance specs (first layer of drum)

Line Pull Lbs. (kgs)	Line Speed Ft./min. (M/min.)	Motor Current	Pull by layer: layer/Lbs (kgs)
0	28 (8.6)	24 amps	1/15000 (6800)
2200 (1000)	10.2 (3.1)	85 amps	2/13900 (6300)
4400 (2000)	7.5 (2.3)	115 amps	3/11400 (5200)
6600 (3000)	6.9 (2.1)	142 amps	4/9700 (4400)
8800 (4000)	6.6 (2.0)	170 amps	
11000 (5000)	6.2 (1.9)	190 amps	
13200 (6000)	5.2 (1.6)	210 amps	
15000 (6800)	4.3 (1.3)	235 amps	

SPECIFICATIONS:

Winch model: M12000
Part numbers: 87801 (12V, CE), 265072 (24V)
Rated line pull: 12000 lbs., (5440 kgs) single-line
Motor: Series wound, 12V 4.6 hp, 24V 2.5 hp
Electrical controls: Contactor
Remote Control: Remote switch, 12' (3.7m) lead
Geartrain: 3-Stage planetary
Gear ratio: 261:1
Clutch (freespooling): Rotating ring gear
Brake: Automatic direct drive cone

Drum diameter/Length: 3.5"/8.2" (9cm/21cm)
Weight: 136 lbs. (62kgs)
Wire rope: 125', 3/8" diameter (38m, 9.5mm diam.)
Fairlead: Roller
Recommended battery: 650 CCA minimum for winching
Battery leads: 2 gauge, 72" (1.83m)
Finish: Argent gray powder coat

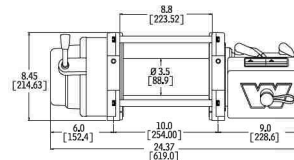

Winch Dimensions:
24.37" L x 8.45" D. x 11" H.
(619mm L x 214.63mm D. x 279mm H.)

Mounting Bolt Pattern:
10.0" x 4.5"
(254mm x 114.3mm)

12V DC performance specs (first layer of drum)

Line Pull Lbs. (kgs)	Line Speed Ft./min. (M/min.)	Motor Current	Pull by layer: layer/Lbs (kgs)
0	30 (9.14)	67 amps	1/12000 (5443)
2000 (910)	14 (4.27)	140 amps	2/11120 (5044)
4000 (1810)	8.62 (2.63)	210 amps	3/10340 (4690)
6000 (2720)	6.92 (2.11)	250 amps	4/9770 (4432)
8000 (3630)	5.80 (1.77)	320 amps	5/9250 (4196)
10000 (4540)	4.39 (1.34)	370 amps	
12000 (5440)	3.86 (1.18)	440 amps	

24V DC performance specs (first layer of drum)

Line Pull Lbs. (kgs)	Line Speed Ft./min. (M/min.)	Motor Current	Pull by layer: layer/Lbs (kgs)
0	31.94 (9.57)	24 amps	1/12000 (5443)
2000 (910)	11.7 (3.57)	105 amps	2/11120 (5044)
4000 (1810)	9.5 (2.90)	129 amps	3/10340 (4690)
6000 (2720)	8.5 (2.59)	152 amps	4/9770 (4432)
8000 (3630)	7.5 (2.29)	175 amps	5/9250 (4196)
10000 (4540)	6.5 (1.98)	198 amps	
12000 (5440)	6.0 (1.83)	221 amps	